

## 74 BRUNSWICK QUAY LONDON, SE16 7PZ

**£1,650 PCM**

Just 0.3 miles from Surrey Quays station or 0.4 miles from Canada Water station, this property is a commuters dream. The property benefits from being fully furnished to a good standard and features a large open-plan living and dining area, large double bedroom and a modern bathroom which has been recently renovated. The property also comes with its own private car parking space as well.

**DouglasPryce**

## 74 Brunswick Quays SE16 7PZ

Approximate Gross Internal Area  
38.1 sq m / 410 sq ft

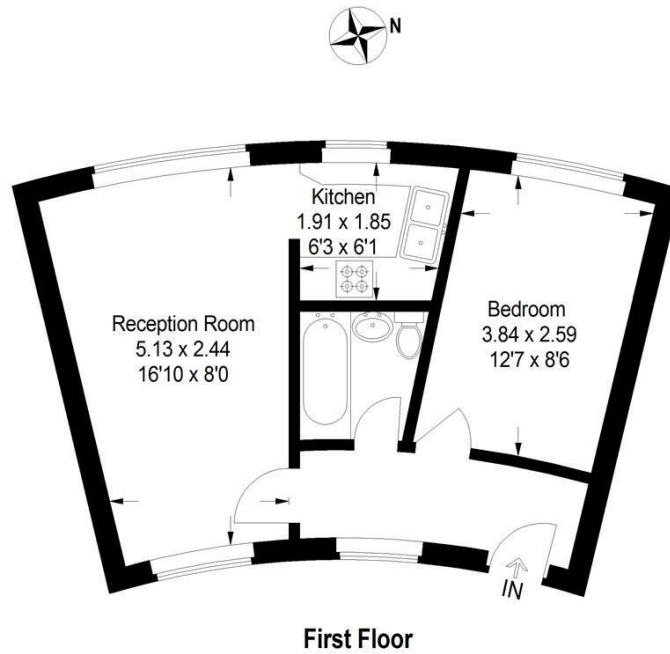

Illustration for identification purposes only,  
measurements are approximate.



Energy Efficiency Rating		
	Current	Potential
Very energy efficient - lower running costs		
(92 plus) A		
(81-91) B		
(69-80) C		
(55-68) D		
(39-54) E		
(21-38) F		
(1-20) G		
Not energy efficient - higher running costs		
England & Wales	EU Directive 2002/91/EC	

Agents Note: Whilst every care has been taken to prepare these particulars, they are for guidance purposes only. All measurements are approximate and are for general guidance purposes only and whilst every care has been taken to ensure their accuracy, they should not be relied upon and potential buyers/tenants are advised to recheck the measurements

Lettings  
Verdant Lane  
London  
SE6 1LF

07887933642  
glenn@douglaspryce.co.uk  
www.douglaspryce.co.uk

**DouglasPryce**